

Contract #
Dates –

SUNSET SPLENDOR

2024 JAYCO GREYHAWK – 31F

CONTENTS

Thank you for choosing Sunset Splendor	2
Drop off and pick Location, Address, TIME, and date	2
Our contact Info.....	2
Optional Features:	2
Video tutorials	2
JAYCO 2024 OWNER’S MANUAL.....	2
Road Assistance Number & Services	2
What is included With your rental.....	3
RetuRning the RV	4
SUNSET SPLENDOR SPECIFICATIONS AND FLOOR PLAN.....	4
FLORIDA STATE PARKS	5
Proof Of Insurance – Provided by RV Share	7
Vehicle Registration.....	7
CAMPGROUND ARRIVAL.....	7
SITE ARRIVAL CHECKLIST.....	8
DEPARTURE CHECKLIST	8
INTERIOR.....	8
PASSENGER AREA	9
EXTERIOR	9
WIFI INFORMATION.....	10

Contract #
Dates –

THANK YOU FOR CHOOSING SUNSET SPLENDOR

Hello (Renters)

Thank you for your interest in renting our beautiful Sunset Splendor As the pickup date gets closer, we wanted to share a few tutorial videos that truly helped us when we were newbies. These videos are of a very similar model but cover most of the basics. We will also go over a lot of these features when you pick her up. There are also some optional features we can add if you'd like, they are below. Please reach out to us if you have any questions.

DROP OFF AND PICK LOCATION, ADDRESS, TIME, AND DATE

Pick up Location: 3132 Addison Blvd, Saint Cloud FL 34771.

Date:

Time: 3:00 pm (Early pick-up is available at a \$75 fee)

Location for drop-off: 3132 Addison Blvd, Saint Cloud FL 34771.

Date:

Time: 9: Perex00 am (Late drop off is available for a \$100 fee. Any drop off after 1:00pm will be considered an extra day)

OUR CONTACT INFO

Minerva Perez – 407—448-1001.

OPTIONAL FEATURES:

1. WIFI - \$45
2. Tent - \$45
3. Hammocks (x2) - \$10
4. Propane Gas Grill - \$45
5. Propane Gas Fire Pit - \$45
6. Bundle options are available - we can negotiate if you would like 2 or more add-ins

VIDEO TUTORIALS

[\(59\) Entegra Coach-Odyssey-31F - YouTube](#) – A walk through

[\(59\) 2020 Entegra Odyssey 31F - Dumping the RV - YouTube](#) – Emptying black and grey tanks

[\(59\) 2020 Entegra Odyssey 31F Propane Tank tutorial - YouTube](#) – Propane Tank

[\(59\) 2020 Entegra Odyssey 31F intro and walk through - YouTube](#) – Inside walkthrough

<https://www.youtube.com/watch?v=pyrMELEz62A> – auto leveling

<https://www.youtube.com/watch?v=qZyH0EY4fE4> – Outside Walkthrough

<https://www.youtube.com/watch?v=1qrds-b37hY> – Operating the slide out

<https://www.youtube.com/watch?v=pFqr9mCTh40> – Water Hose

https://www.youtube.com/watch?v=j9E6ekQ5a_E – Main Control

JAYCO 2024 OWNER'S MANUAL

<https://www.jayco.com/rvs/class-c-motorhomes/2024-redhawk/31f/>

Contract #
Dates –

ASSISTANCE NUMBER & SERVICES

[855\) 229-9696](tel:8552299696).

WHAT IS INCLUDED WITH YOUR RENTAL

General Essentials

- Electrical hookup cords
- Electrical cord extension
- Sewer hose
- Surge Protector
- 50amp to 30amp adapter
- Sewer hose extension
- Water hose (2)
- Water pressure regulator
- Emergency kit
- Tool Kit
- Duct tape
- WD-40
- RVMinders
- Sewer hose support
- Spare Tire
- Water Filter
- Bucket
- Gloves

RV Living Essentials

- Bedding includes sheets, covers, pillows, blankets, pillowcases, mattress pads.
- Window coverings
- Games
 - Cleaning supplies including sponges, trash bags, hand vacuum, Clorox wipes, paper towels
- Aluminum foil
- Portable fans (for an additional fee)
- Swiffer dry/wet mop
- Mobile hotspot//WIFI (for an additional fee)
- First Aid Kit
- Broom and dustpan set
- Fuses

RV Kitchen Essentials

- Dishes
- Cups

- Silverware
- Air Fryer
- Measuring Cups
- Nesting Bowls
- Bottle opener
- Can opener
- Cooking utensils and vessels — large spoons, pots, pans, skewers
- Cutting board and knives
- Dish Towels
- Paper towels
- Coffee mugs and coffee
- Toaster
- Air Fryer
- Coffee maker
- Mini waffle maker
- Drying Rack
- Sponge
- Collapsible strainer
- Potholders
- Insulated cooler
- Lighters

RV Bathroom Essentials

- Toothpaste/ toothbrush, shampoo/ conditioner, body wash, lotion, razor)
- Bath and hand towels/ wash sponges
- RV-friendly toilet paper — Regular toilet paper can easily gum up your RV's delicate sewer system
- RV toilet chemicals
- Genie
- RV toiler cleaner
- Q-Tips
- Toilet bowl brush
- Clothesline and clothespin
- Sunscreen
- Bug Repellent bracelets

RV Outdoor Essentials

- Flashlights
- Hammocks (for an additional fee)
- Tent (for an additional fee)
- Beach towels
- Rope
- Propane Fire Pit (for an additional fee)
- Propane grill (for an additional fee)
- Outdoor camping furniture like folding chairs
- Outside Mat - Large outdoor ground covering for under the awning

Contract
Dates –

RETURNING THE RV

Please return RV with a full tank of gas, there will be a \$225 fee if not filled upon return.

Please return the RV as you picked it up. There will be a \$150 cleaning fee upon return depending on the level of uncleanness.

Please return RV with a black and gray water tank empty, there will be a \$125 fee if not discharge tanks upon return RV

Please return RV with full propane tank.

Any tolls charged to the RV will be deducted from your deposit.

SPECIFICATIONS AND FLOOR PLAN

Specifications	
Weights	
Gross Vehicle Weight Rating (lbs)	14,500
Gross Combined Weight Rating (lbs)	22,000
Measurements	
Exterior Length (overall)	32' 6"
Exterior Height (with A/C)	11' 8"
Exterior Width	8' 4"
Exterior Width (with slides out)	9' 10"
Interior Height (main)	7' 0"
Awning Length	18' 0"
Tank Capacities	
Fresh Water Capacity (gals)	47
Gray Water Capacity (gals)	41
Black Tank Capacity (gals)	31
Propane Unit (lbs)	56
Fuel Tank Capacity (gals)	55
Miscellaneous	
Sleeps	up to 10
Tire Size	LT225/75R16E
Engine Size	7.3L 2V DEVCT NA PFI V8
Exterior Cargo Capacity (cu. ft.)	51

Contract
 Dates –

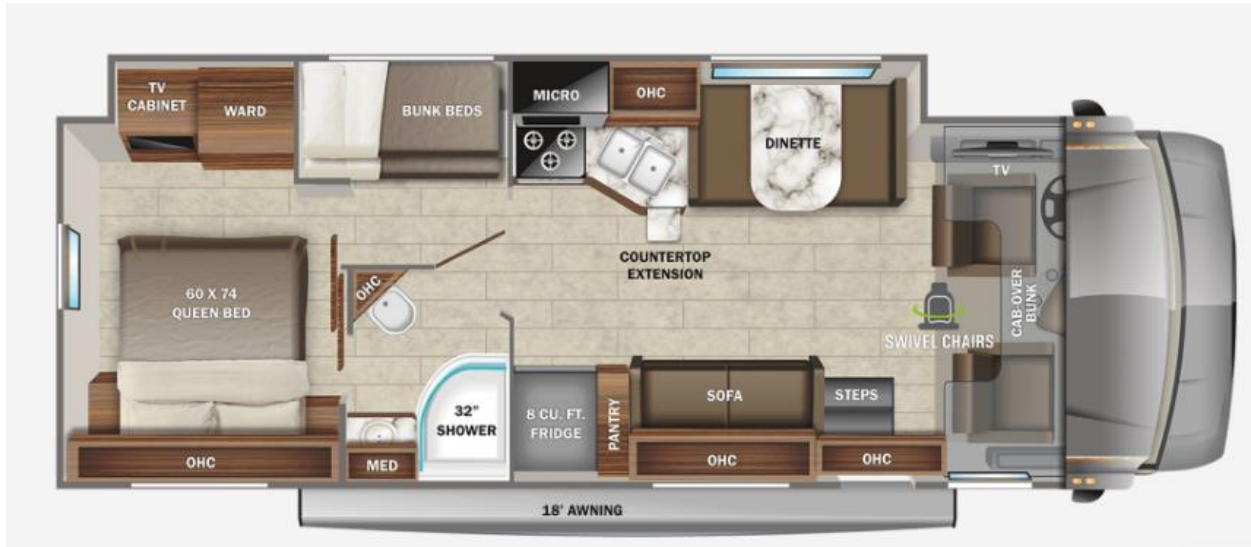

FLORIDA STATE PARKS

Florida State Parks	
Alafia River State Park	Owner Recommends
Anastasia State Park	Owner Recommends
Bahia Honda State Park	Owner Recommends
Blackwater River State Park	Owner Recommends
Blue Spring State Park	Owner Recommends
Colt Creek State Park	
Curry Hammock State Park	Owner Recommends
Falling Waters State Park	
Florida Caverns State Park	Owner Recommends
Fort Clinch State Park	Owner Recommends
Fred Gannon Rocky Bayou State Park	
Grayton Beach State Park	
Henderson Beach State Park	Owner Recommends
Highlands Hammock State Park	
Hillsborough River State Park	
John Pennekamp Coral Reef State Park	Owner Recommends
Jonathan Dickinson State Park	Owner Recommends
Kissimmee Prairie Preserve State Park	
Koreshan State Park	
Lake Griffin State Park	

Contract

Dates –

Lake Kissimmee State Park	Owner Recommends
Lake Louisa State Park	
Lake Manatee State Park	
Little Manatee River State Park	
Little Talbot Island State Park	
Long Key State Park	
Manatee Springs State Park	
Myakka River State Park	Owner Recommends
Ochlockonee River State Park	
Oscar Scherer State Park	
Paynes Prairie Preserve State Park	
Rainbow Springs State Park	Owner Recommends
Sebastian Inlet State Park	
Silver Springs State Park	
Stephen Foster Folk Culture Center State Park	
Suwannee River State Park	
Three Rivers State Park	
Tomoka State Park	
Topsail Hill Preserve State Park	
Torreya State Park	
Wekiwa Springs State Park	

Contract
Dates –

PROOF OF INSURANCE – PROVIDED BY RV SHARE VEHICLE REGISTRATION

				CO/AGY	6 / 8	T#	1774454633		
						B#	1322269		
FLORIDA VEHICLE REGISTRATION									
PLATE	26AXZC	DECAL	00671860	Expires	Midnight Sat 3/1/2025				
YR/MK	2022/JYGR	BODY	MH	COLOR	MUL	Reg. Tax	112.70	Class Code	42
VIN	1FDXE4FN8NDC28513			TITLE	145348743	Init. Reg.		Tax Months	24
Plate Type	RGS	NET WT	12867			County Fee	6.00	Back Tax Mos	
DL/FEID	D525652680810			2ND DL#	M235420737530	Mail Fee		Credit Class	
Date Issued	2/27/2023	Plate Issued	1/19/2022			Sales Tax		Credit Months	
						Voluntary Fees			
						Grand Total	118.70		

OWEN LEE DUNCAN, JAYLYN MESA-DUNCAN
15968 WHIPPOORWILL CIRCLE
CITY OF WESTLAKE, FL 33470

RGS - SUNSHINE STATE

IMPORTANT INFORMATION

1. The Florida license plate must remain with the registrant upon sale of vehicle.
2. The registration must be delivered to a Tax Collector or Tag Agent for transfer to a replacement vehicle.
3. Your registration must be updated to your new address within 30 days of moving.
4. Registration renewals are the responsibility of the registrant and shall occur during the 30-day period prior to the expiration date shown on this registration. Renewal notices are provided as a courtesy and are not required for renewal purposes.
5. I understand that my driver license and registrations will be suspended immediately if the insurer denies the insurance information submitted for this registration.

CAMPGROUND ARRIVAL

- Before arriving, confirm that GPS directions are correct. Take a look at the campground entrance on the Google Maps app so that you know what the entrance looks like and what to watch for. We recommend downloading an RV Maps app – RV Life



- Arrive at the campground and look for the registration area.
- Slowly maneuver into the Check-In Lane while not blocking other lanes. Stop where noted.
- Grab your wallet, confirmation documents, dog records, and snap a picture of the license plate on the way into the office— just in case they need it.
- Check-in. Ask if they include discounts for RV memberships or military, Police, etc.
- Confirm that the site assigned will fit the RV and requirements.
- Receive your check-in pamphlet with directions to the site, campground information, gate codes, rules and regulations, and Wi-Fi password.
- If the campground does not offer full hookup, determine where the dump station and freshwater fill is to visit on your way to the site.

Contract
Dates –

- Ask any other questions you may have. For example: What time does the office/pool close? Do they bring firewood to the site? What activities are going on? Do they have propane?
- Jump in and drive slowly to your designated campsite!
- Stop at the dump station and freshwater fill station, if needed.

SITE ARRIVAL CHECKLIST

- Select as flat and level a parking site as possible, consistent with other considerations
- Place the shift lever in park and set the parking brake. The automatic hydraulic leveling system will not operate unless these conditions are met
- Engage the automatic hydraulic leveling system to level and stabilize the coach, with the engine running to provide alternator power.
- Confirm jacks are down
- Turn off the engine and extend any desired slide outs once the unit is leveled and secured
- Turn the powered steps on (bottom switch in the door well placed up), open the main door to extend the steps, then turn the powered steps off (same switch down) to prevent repeated cycling of the steps every time the door is opened or closed. (Steps powered by the engine battery)
- Check the site's 30-amp shore power receptacle for proper polarity prior to hook up, if applicable
- Connect the surge protector to the sites power receptable
- Connect the coach's 30-amp shore power cord to the surge protector
- Ensure that the coach's automatic electrical transfer switch has accepted the shore power (by checking that the microwave's 120 vac display is lit)
- Ensure that the refrigerator (in auto mode) has shifted to electrical power (sometimes this will take a few minutes)
- Connect the water pressure regulator to the camp site's water source
- Connect the coach's city water hose to the water pressure regulator
- Set the water controls to accept city water
- Confirm there is water available inside the coach (open any faucet)
- Connect the coach's dump hose to the site's sewage receptacle using the coach's hose slope adapter, if applicable. **DO NOT OPEN DUMP TANK OR GREY TANK VALVES UNTIL YOU ARE READY TO DEPART SITE.**
- Ensure that the coach's propane tank is open
- Install bear spray by the door, if applicable
- Arrange the patio accessories, if applicable
- **CALL US IF YOU HAVE ANY QUESTIONS**

DEPARTURE CHECKLIST

INTERIOR

- All loose Items stored
- Cupboard doors and drawers closed
- All vents closed
- Windows closed
- Refrigerator items secured
- Shower door closed and secured
- Ensure that the refrigerator (in auto mode) has shifted back to propane power (this is after your disconnect from the site's power receptable/source).
- Pick up loose items from the floor and slide rooms in and secured

Contract

Dates –

- Interior doors secured
- Turn off water heater/furnace/air conditioner
- Discard trash/recycling
- Auto-Leveling jacks extracted
- Ensure that the oven pilot light is off
- Ensure that the water heater is off
- Ensure that the freshwater pressure pump is off
- Check all tank level indications
- Close the main door to retract the powered steps
- Lock both main door locks (this keeps door from flying open during travel)

PASSENGER AREA

- Drink/coffee cups filled
- Seat belts located
- Note mileage in Camping Journal
- Music/radio ready
- Maps/Route/GPS ready
- Kids games/books/music/videos/snacks ready
- Cell phone
- All keys accounted for
- Sunglasses
- Tissues/wet wipes
- Pets walked & happy

EXTERIOR

- Drain holding tanks
 - Open black valve first, once completed then
 - Open gray valve
- Flush holding tanks
- Check freshwater tank level
- Power, water, sewer, cable, etc. unplugged from RV
- Propane
- Range vent secured
- Outside storage bay door secured/locked
- Raised auto-leveling jacks
- Remove wheel blocks if any used
- Windshields cleaned
- Tire pressure checked
- Fluid levels checked
- Entry steps stowed AT DEPARTURE
- Safety inspection – turn signals, brakes, headlights
- RV walk-around: windows, slide rooms, roof vents, steps
- Safety inspection
- Inspect camping site for left items, litter

Contract
Dates –

- **CALL US IF YOU HAVE ANY QUESTIONS**

WIFI INFORMATION

Network Name: additional fee

(Which ever gives you a better signal, 5GHz usually works best inside RV, sometimes 2.4 is best outside RV)

Password: